

## Happening Projects



### **New Office building for the Tiber Property Group, Rosebank**

A new office development, which comprises eight levels of offices spanning some 6,500m<sup>2</sup> and three levels of parking, one below ground, providing 250 bays in total, has been developed and is underway in Rosebank. The façade features huge concrete boxes which are cantilevered off the main building, while the exterior of the building is fully tiled with a glazed façade to the east of the building. Located as it is on the corner of Oxford and Jellicoe roads in Rosebank, this building is ideally situated to benefit from the nearby Gautrain station.

#### **Client & Developer:**

Tiber Property Group

**Project Managers:** Tiber Projects

**Architects:** Paragon Architects

**Quantity Surveyors:**

IBP Construction Consultants

**Consulting Engineers:**

**Structural & Civil:**

WSP Structures Africa

**Mechanical:**

C3 Climate Control Consulting Engineers

**Electrical:**

Excell Consulting Electrical Engineers

**Fire Protection:** TWCE

**Plumbing Consultant:**

Ramsden Consulting

**Main Contractor:**

Tiber Bonvec Construction

**Completion:** ± April 2010

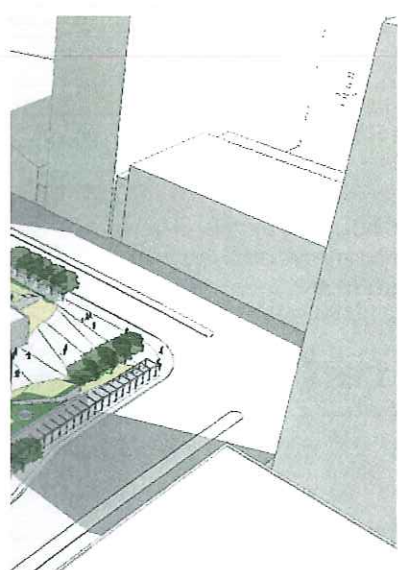

st  
 The project will cost ±R162mn (US\$16mn) and will be fully financed through capital contributions. Construction on the Desmond Tutu Peace Centre is due to begin in September 2009 and completed in 2011.

#### **Architects:**

Paragon Architects

Paragon Architects

**Project Manager:**

IBP Construction Project Management

**Quantity Surveyor:**

IBP Construction Consultants

**Consulting Engineers:**

**Structural & Civil Engineer:** AKI/Axis

WSP Structures Africa

**Mechanical:** C3 Climate Control Consulting Engineers

**Electrical:**

Excell Consulting Services; Agama Energy

#### **SERVICES TO BE PROCURED:**

Architect and Surveyor

Geotechnical Engineer

Urban Designer

Town Planner

Community Facilitator

